

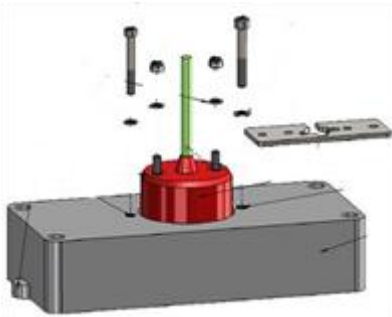

Welcome to the May newsletter from SKIPPER Electronics AS.



The retrofit of SKIPPER DL850 Doppler Speed Log to Atlas DOLOG 2x is a great success!

The SKIPPER DL850 Doppler Speed Log sensor has been available with adaptor to fit to the existing tank used for Atlas DOLOG 2x for some time now, and we see that there are now several installations with great success!

SKIPPER DL850 is a dual axis doppler speed log. The SKIPPER DL850 will provide Speed Through Water (STW) and Speed Over Ground (SOG) in dual axis. It does also include docking functionality when connected to the ROT.

The part numbers needed for this retrofit solution is:

- DL850D27-SD Log operator unit DL850 270 kHz with docking
- DL850T27-SB Log transceiver unit for DL850 270kHz SKIPPER
- DL850S27DR-SB Log Sensor Dolog retrofit DL850S27 w sealed cable end

The adaptor plate is now changed from steel to plastic so it is lighter and easier to change by the use of a diver!

The advantage for this retrofit solution is that you do not need to change the existing tank. You use the existing Dolog tank on board, and install the DL850 sensor into this tank. Electronics and display also need to be replaced.

In most cases the existing NMEA repeaters may be used.

Please contact sales@skipper.no for your quotation.

[For more information regarding SKIPPER DL850 please click here!](#)

Training Courses 2018

According to the interest in training courses noted on the December newsletter 2017 we will be arranging courses in the following areas:

Date	Place	Host Comany	Duration (Days)
10-13th. September	Oslo, Norway	SKIPPER Electronics	4
13-16th. November	Singapore	Jason Electronics	4

SKIPPER Company Evaluation

SKIPPER would like your feedback regarding our products and service. The evaluation will take 2 minutes.
Please enter the evaluation here: [Company Evaluation](#)

Best regards,

Sigurd H. Paulsen
Managing Director
SKIPPER Electronics AS
Phone: +4723302270
Fax: +4723302271
sales@skipper.no
<http://www.skipper.no>