

SKIPPER DGR 360

Remote Gyro/HDT/THS indicator

Digital repeater

Gyro course

NMEA signals

HDT/THS



DGR 360 is a digital gyro repeater that displays the Heading Angle in the LED segment display and indicates the Direction of Turn with 30 dual-color surrounding LED's, changing from green to red colour depending on the direction of turn.

SKIPPER Electronics manufacture marine electronics for the merchant fleet as well as the fishing fleet, based on experience, research and tradition. Our products are known worldwide for reliability, sophistication and good value for money.

Features:

Digital gyro repeater
Heading angle
HDT/THS signals
Bracket or panel mounting.

The DGR 360 will display Heading Angle given by the heading message from a gyro or other equipment (NMEA0183, Version 2.30) and indicate Direction of Turn by calculating change in heading based on the HDT/THS input and the time between each message.

The dimming may be controlled by pressing the dimming key or by using an external dimming key.

SKIPPER DGR 360

Remote Gyro/HDT/THS indicator

Specifications

Overview

Power Supply	DC: 20 - 32 V
Power Consumption	2 W at 24 V
Display	1 line with 7 segments 30 x 20 mm
Display outputs	Heading (HDT, THS) from gyro compass or other HDT/THS devices Analogue indication of turn direction (Red/Green LEDs)
Standard Cable length	2 m
Compass safe distance	85 cm
Cut-Out Dimensions	190 x 158 mm. Bracket or panel mounting
Front plate	220 x 170 mm
Depth.	63 mm
Weight cabinet	2 kg
Protection	IP 56
Outputs	NMEA 0183
Inputs	NMEA 0183 Sentence: \$--HDT, \$--THS Remote dimmer input
Classification	IEC 60945/2002
Service	Available in most major harbours, world-wide through extensive dealer network

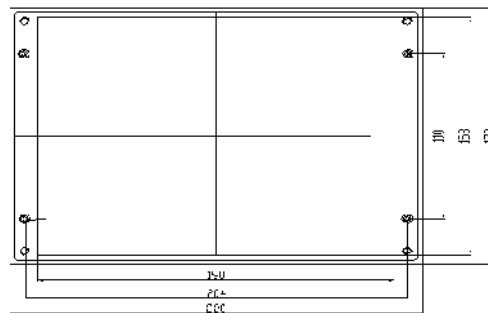
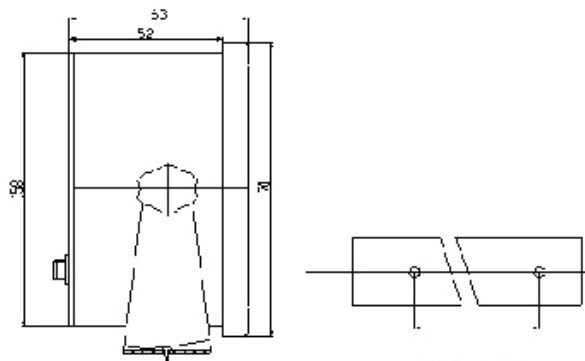
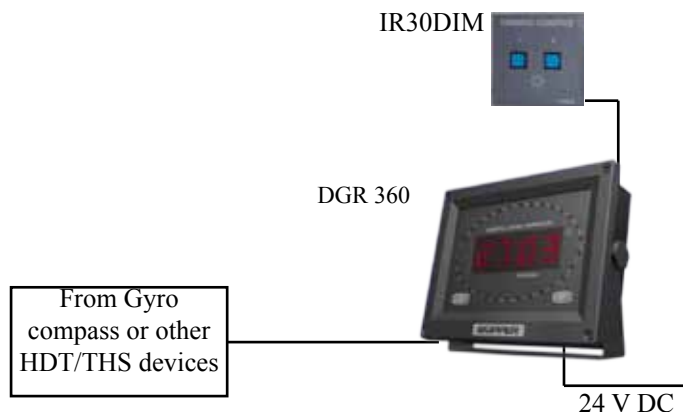

SKIPPER

SKIPPER Electronics AS

Enebakkveien 150

P. O. Box 151, Manglerud

0612 Oslo, Norway

E-mail: sales@skipper.no

Telephone: +47 23 30 22 70

Telefax: +47 23 30 22 71

Co. reg. no: NO-965378847 - MVA

www.skipper.no

Date: February 2010

Revision: 24022010